

※ Please complete the code pairing between receiver and remote control before assembling the TV mount to the ceiling.

*About how to use, you can see YouTube video:

<https://youtu.be/zPYwWxyAJ2M>

You can also scan the QR code to check it:

TOPSKY TV01.01 NEW VER - HOW TO USE REMOTE



TOPSKY TV01.01
Electric Height
Adjustable TV Stand

ABOUT TOPSKY 3 YEAR WARRANTY:

This Product come with 3 year warranty from the date of purchase. Any failure/function issues from normal usage will be replaced free of charge or refund once within 3 year of the date of purchase. A failure is a mechanical breakdown of or defect in the unit that affects the user's ability to operate the product as intended.

WARRANTY COVERAGE:

All the parts

NOT INCLUDE:

Misuse or abuse of the product

Customers personal preference changed

Normal appearance loss

Parts lost by customer

TOPSKY Accessories/Replacement Part For out of Warranty Paid Service.

We also offer paid service/parts and extend warranty for the part out of Warranty.

If exceed quality warranty period, or you have already performed a warranty service once during the period, and still want to be able to perform the warranty service.

If you ever have any inquiry's regarding whether or not your product is still under warranty/ how to buy extra part, paid service Just search and contact TOPSKY service team or call us.

Caution



Keep children and pets away from the electric ceiling TV stand during operation. Unplug the power cable during a thunderstorm or if you do not intend to use the mount for a long time.



Be careful not to place your hands on or near the moving joints when folding or unfolding the TV stand to avoid any pinching.



Ensure there no obstacles around the TV stand's extension area.



It is strictly forbidden to disassemble the products privately to avoid that the failure of the products or the damage to the human body caused by electronic products, etc.



This product is designed for installation on wood ceiling joists or wood wall. DO NOT install on drywall alone.



Please read the following instructions carefully before start using the TV stand. The company does not bear any warranty or liability for damage and human injury caused by any abnormal operation.



It is necessary to reset manually after the initial installation or power off.

Parts List

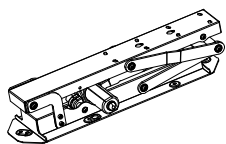

A (x1)
Mount



B (x1)
Center Plate



C (x1)
Ceiling Template

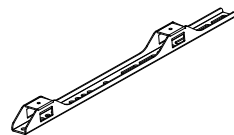

D (x2)
VESA Bracket

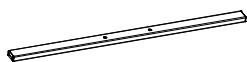

E (x2)
Bracket Rail



F (x1)
AC Adapter



G (x1)
Receiver
(Receiver may be pre-installed
on A due to factory test.)



H (x4)
Cable Tie



I (x4)
M6x16mm Screw



J (x4)
M6x30mm Screw



K (x4)
M6x16 Black
Washer



L (x4)
M6 Nut



M (x4)
M4x6mm Screw



N₁ (x4)
M5x14mm Screw



N₂ (x4)
M6x14mm Screw



N₃ (x4)
M6x30mm Screw



N₄ (x4)
M8x30mm Screw



N₅ (x4)
M8x50mm Screw



N₆ (x4)
Square Washer



N₇ (x8)
Small Spacer



N₈ (x8)
Large Spacer



O₁ (x6)
ST6.2x55mm
Screw



O₂ (x6)
Concrete Anchor



O₃ (x4)
16x6.5 Galvanized
Washer



P (x1)
5x80 Allen Wrench

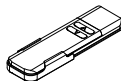

Q (x1)
Remote



R (x5) M6x10
Screw
(pre-installed on B)

TOOLS NEEDED:



Phillips Screwdriver

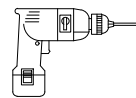

Drill



Pencil

NOTE: SOME HARDWARE INCLUDED MAY NOT BE USED

Assembly

STEP 1: Installing the Mount

OPTION A: Wood Ceiling

Using Ceiling Template (C), mark exact location of mounting holes. Drill pilot holes 2.2" deep using a 4.5mm drill bit. Insert two ST6.2x55mm Screws (O1), leaving a 5mm gap from ceiling. Hang Mount (A) so that the screws fit into the keyhole openings. Slide Mount (A) backward, then secure using additional ST6.2x55mm Screws (O1) with 16x6.5 Galvanized Washers (O3).

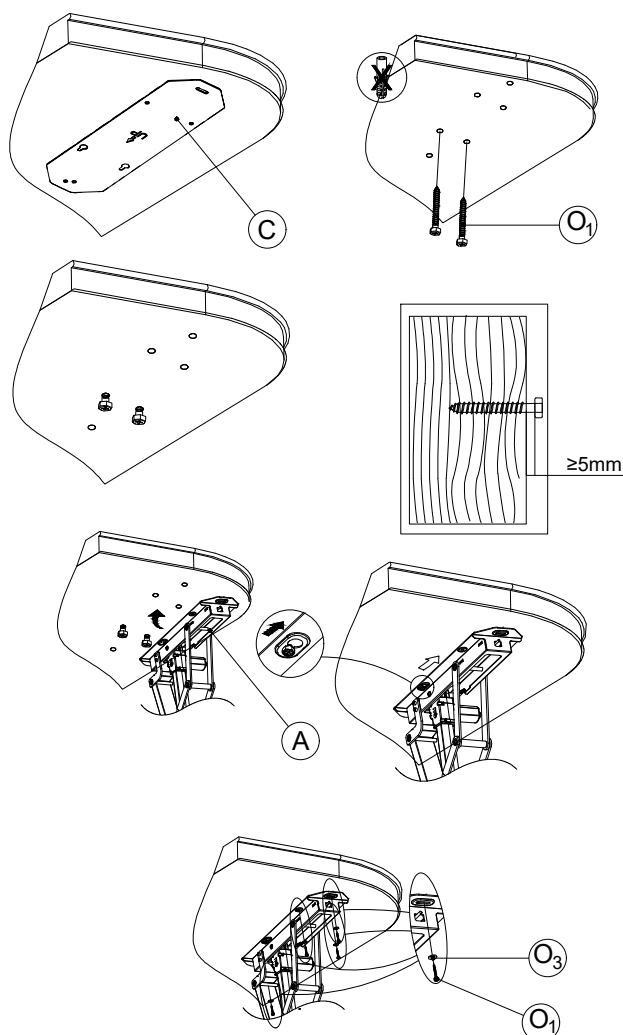

NOTE: If mounting to a wood beam ceiling, ensure the front and back holes are used for the main support if mount is in line with the beam. If perpendicular to the beam, use keyhole openings for the main support. **Do NOT** use included Concrete Anchors (O2) for wood or drywall.

✖Please complete the code pairing between receiver and remote control before assembling the TV mount to the ceiling.

OPTION B: Concrete Ceiling

Using Ceiling Template (C), mark exact location of mounting holes. Drill pilot holes 2.4" deep, using a 10mm drill bit. Insert six Anchors (O2), then tighten two ST6.2x55mm Screws (O1), leaving a 5mm gap from ceiling. Hang Mount (A) so that the screws fit into the keyhole openings. Slide Mount (A) backward, then secure using additional ST6.2x55mm Screws (O1) with 16x6.5 Galvanized Washers (O3). Tighten all screws.

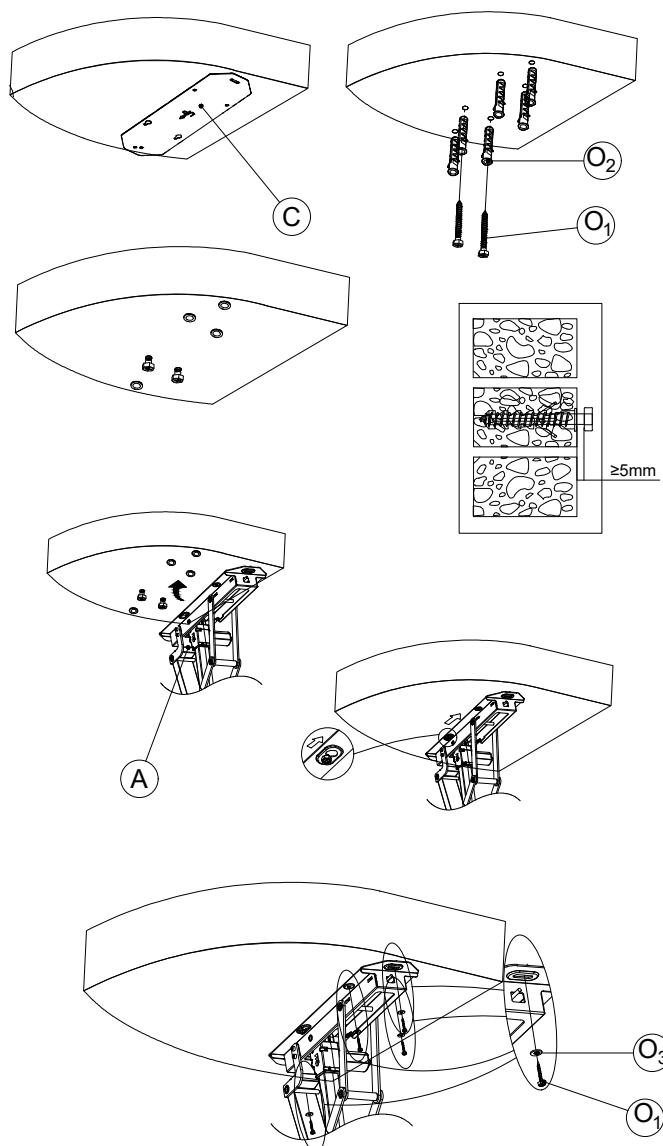

NOTE: O1 Concentric installation, do not tilt installation



Checklist

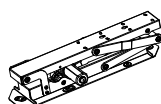

A (x1)
Mount

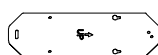

C (x1)
Template



O1 (x6)
ST6.2x55mm Screw



O2 (x6)
Concrete Anchor



O3 (x4)
16x6.5 Galvanized
Washer

Assembly

STEP 2:Assembling VESA Components

Assemble Bracket Rails (E) to Center Plate (C) using M6x30mm Screws (J), M6x16 Black Washer (K) and M6 Nuts (L). While holding M6 Nuts (L) with a wrench, use a Phillips screwdriver to tighten M6x30mm Screws (J). Slide VESA Brackets (D) onto Bracket Rails (E) and secure using M4x6mm Screws (M) and 5x80 Allen Wrench(P) .

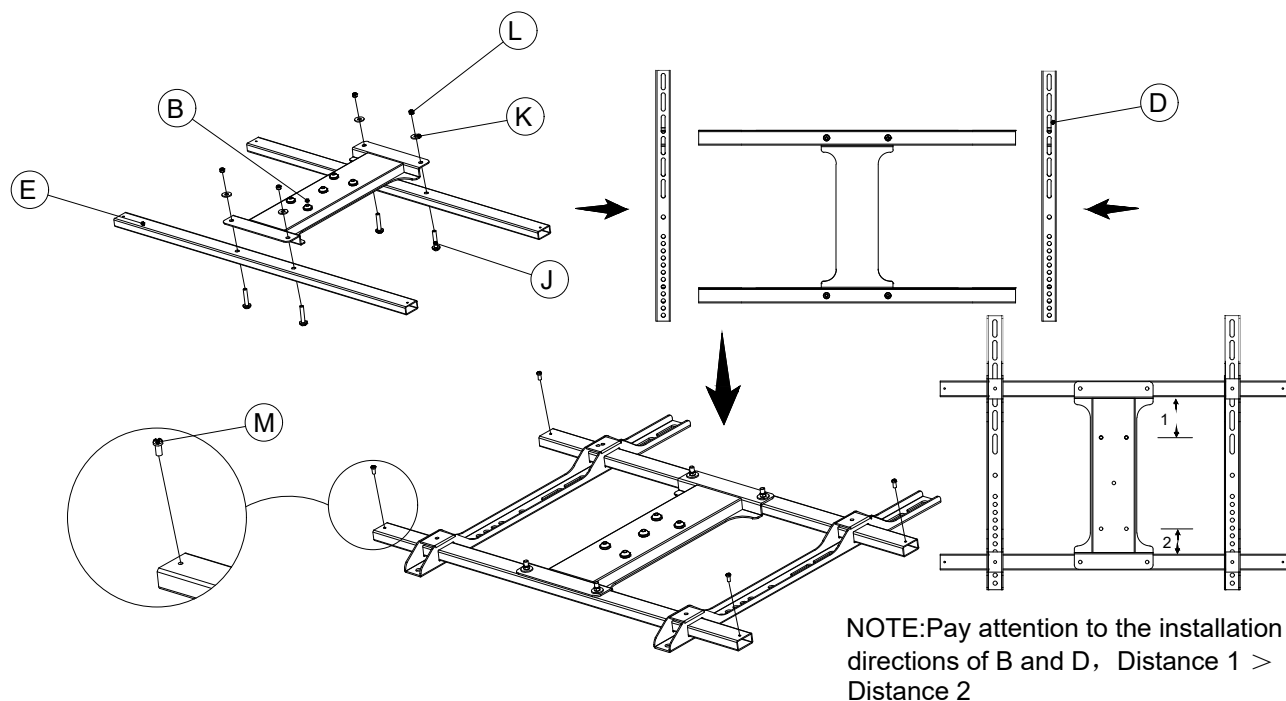

Adjust VESA Brackets (D) spacing to match TV mounting holes, and lock in place using Set Screw (I) and 5x80 Allen Wrench(P) .Remove the four pre-installed M6x10 screws(R) from Center Plate (B) and loosen the center screw until 5mm of thread is exposed.

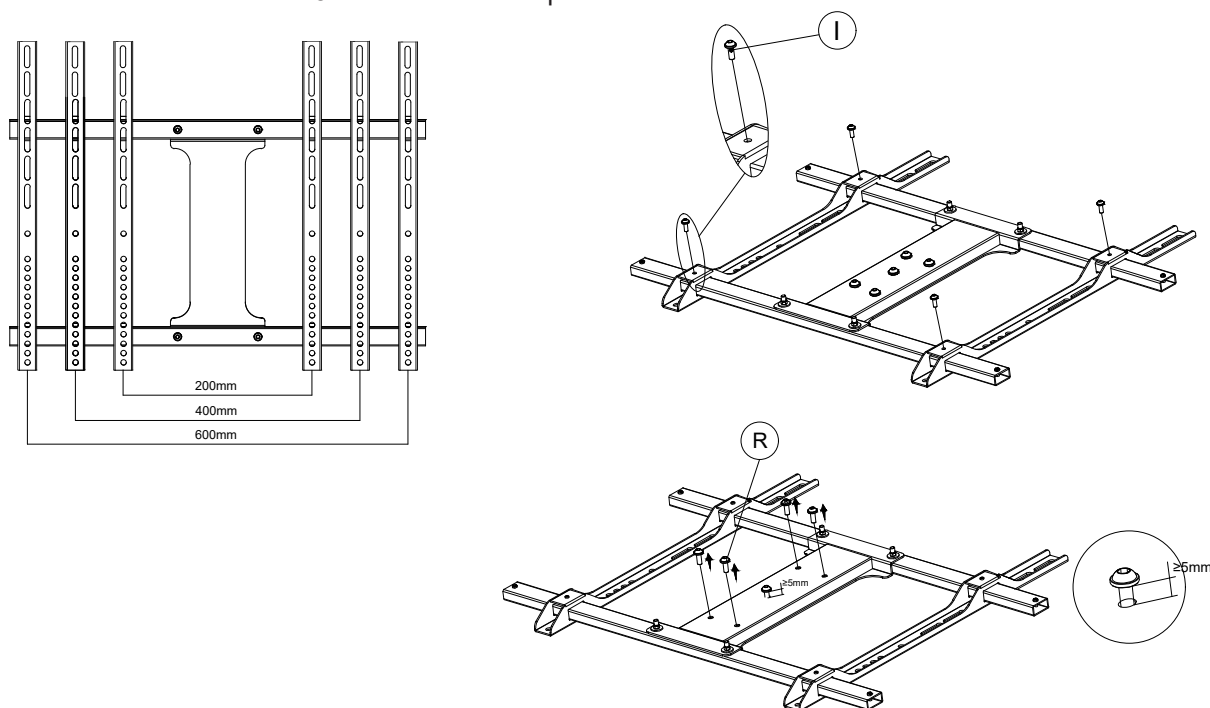

Checklist

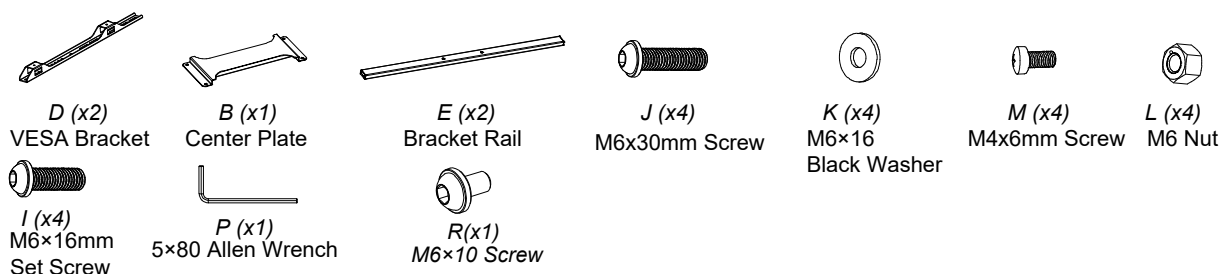

Assembly

STEP 3: Mounting VESA Assembly

OPTION A: Flat Back TV

Align the VESA bracket assembly with the mounting holes in the back of the TV screen. Install assembly to TV using appropriate screws (N1, N2) and Square Washers (N6) according to your screen's requirements.

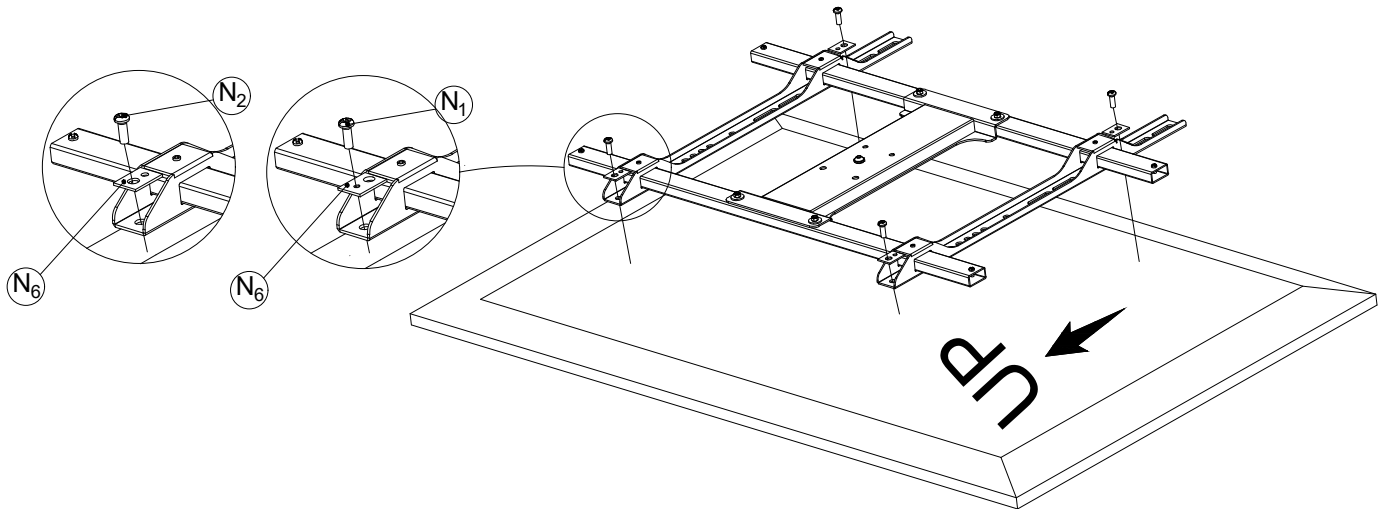

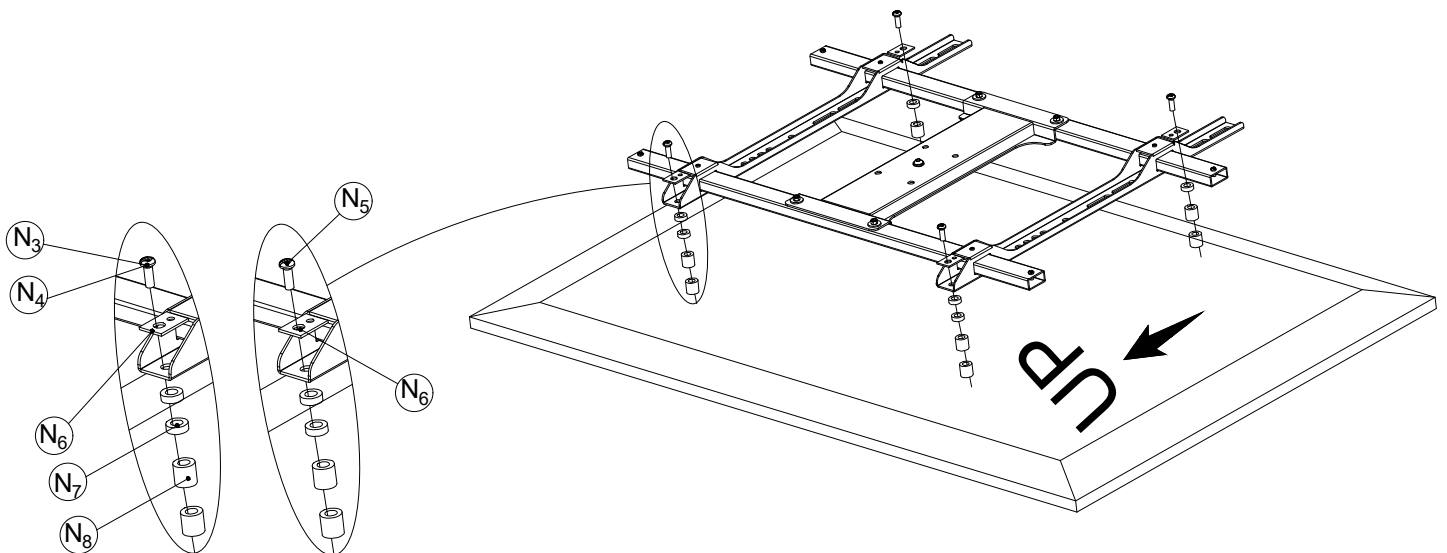

OPTION B: Curved/Recessed Back TV

Align the VESA bracket assembly with the mounting holes in the back of the TV screen. Install assembly to TV using appropriate screws (N3, N4, N5), Square Washers (N6) and Spacers (N7, N8) according to your screen's requirements.

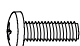

Checklist

N₁ (x4)
M5x14mm Screw

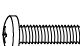

N₂ (x4)
M6x14mm Screw

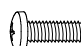

N₃ (x4)
M6x30mm Screw

N₄ (x4)
M8x30mm Screw

N₅ (x4)
M8x50mm Screw

N₆ (x4)



N₇ (x8)

N₈ (x8)

Assembly

STEP 4: Place TV on Mount

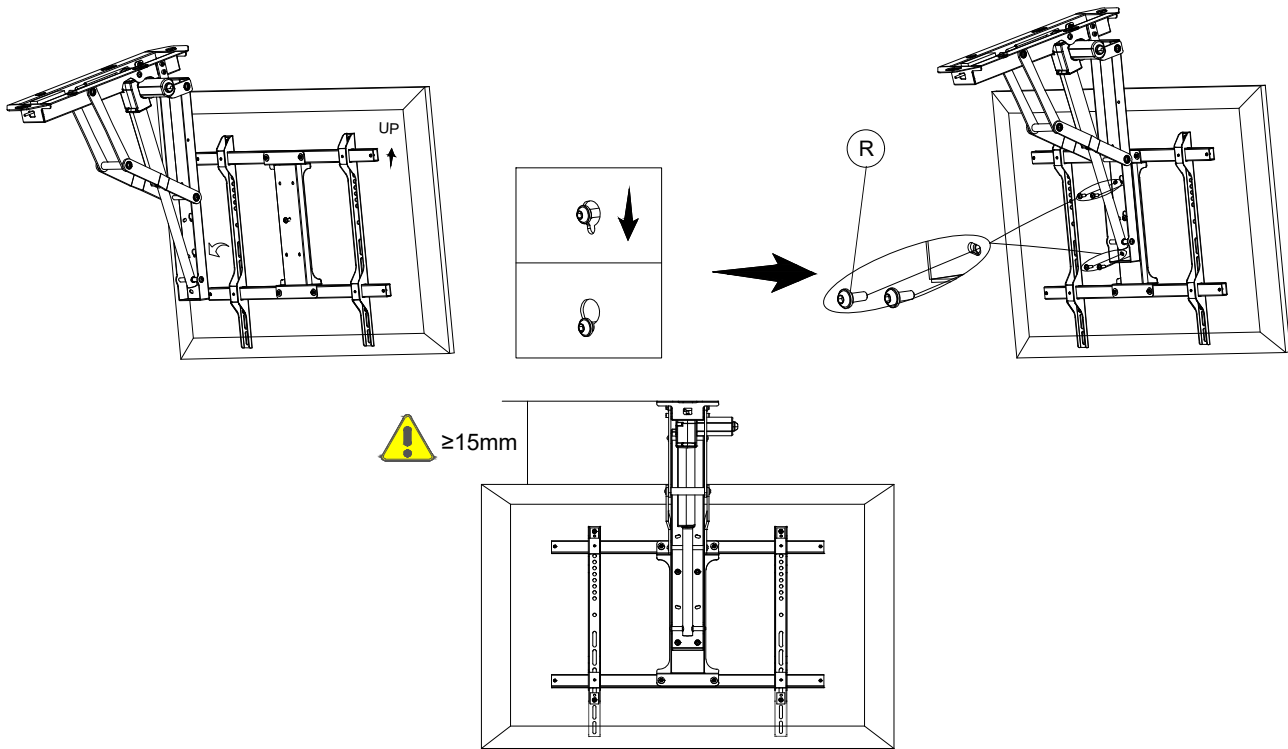
Place the TV with VESA bracket assembly on Mount **(A)** by inserting the center screw on Center Plate **(B)** into the keyhole on Mount **(A)** at the desired height. Secure using other four M6×10 Screws **(R)** and tighten them. Clearance between the ceiling and top edge of TV should be no less than 15mm when TV is in the fully lowered position.



STEP 5: Connect Receiver and AC Adapter

Connect the receiver **(G)** to the Mount **(A)** and AC Adapter **(F)**. And plug the AC Adapter **(F)** to AC outlet. Follow Remote **(Q)** instructions for operation. NOTE: Plugging AC Adapter into AC outlet prior to the mount may cause a large spark when connecting to the mount.

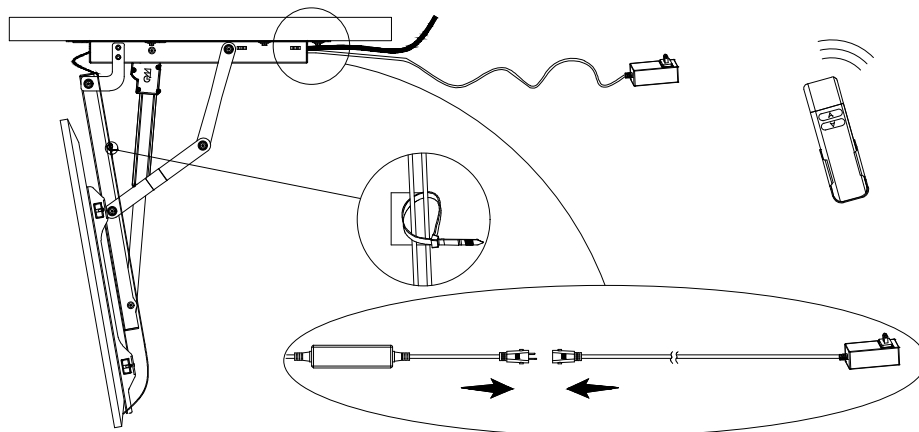

Checklist

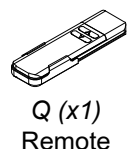
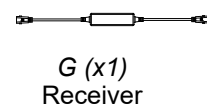
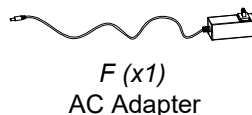
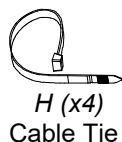

CONTROL SYSTEM INSTRUCTION

Remote	
Operating Voltage	3V (Two AAA battery)
Operating Current	13mA
Quiescent Current	Less than 5 μ A
Operating Frequency	2.4G
Operating Distance	30 meters of open space (Receiver on the ground or on a metal surface will affect the reception distance.)
Coding Methodology	Intelligent micro controller coding is utilized to guarantee the uniqueness of each remote control code.
Operating	<p>Automatic mode:</p> <p>Press ▲ button to fold the TV mount.</p> <p>Press ▼ button to unfold the TV mount.</p> <p>Press ▲ or ▼ button during folding/unfolding, the motor stops.</p> <p>Touch moving mode:</p> <p>Keep holding ▲ button to fold the TV mount.</p> <p>Keep holding ▼ button to unfold the TV mount.</p> <p>Release the button during folding/unfolding, the motor stops.</p>

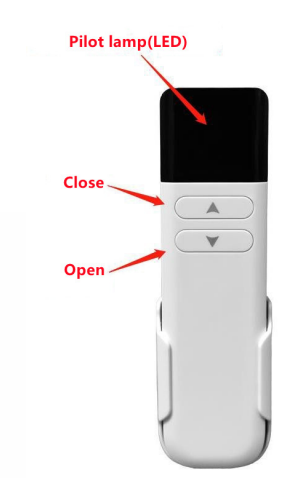

Screw the base of the remote control to the proper position by **ST3X12 Screws**.

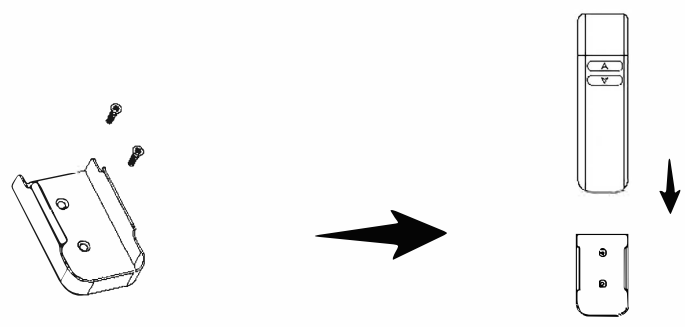

Receiver	
Input	DC29V
Output	Control direct current (DC) (Motor Forward and Reverse Rotation)
Operating voltage	DC12~30V
Quiescent current	15mA
Operating Current	Less than 40mA
Rated Current	Less than 5A
Rated Power	Less than 150W
Operating frequency	2.4G
Code Pairing	After powering on the TV mount, use a ball pen or any similar item (to be prepared by yourself) to press the Function Key. Next, press any key on the remote within 3 seconds to complete the code pairing process.
Code Clearing	After powering on, keep holding the function key for more than 5 seconds to undo the code pairing. Once undone, the remote will no longer be able to control the TV mount.
Switch Mode	With the TV mount power-off status, hold the function key. Keep holding the function key and power on the TV mount. Release the function key after powering on. By following these steps, you can switch between automatic mode and touch moving mode.
*Note	One receiver can be paired with up to 3 remotes. However, when the 4th remote control is successfully paired, the first remote control will be automatically unpaired.

