

TOPSKY TV01.11.01

**Manual Swivel Base
for TV Mount**

Warranty

ABOUT TOPSKY 1 YEAR WARRANTY:

This Product come with 1 year warranty from the date of purchase. Any failure/function issues from normal usage will be replaced free of charge or refund once within 1 year of the date of purchase. A failure is a mechanical breakdown of or defect in the unit that affects the user's ability to operate the product as intended.

WARRANTY COVERAGE:

All the parts

NOT INCLUDE:

Misuse or abuse of the product

Customers personal preference changed

Normal appearance loss

Parts lost by customer

TOPSKY Accessories/Replacement Part For out of Warranty Paid Service.

We also offer paid service/parts and extend warranty for the part out of Warranty.

If exceed quality warranty period, or you have already performed a warranty service once during the period, and still want to be able to perform the warranty service.

If you ever have any inquiry's regarding whether or not your product is still under warranty/ how to buy extra part, paid service Just search and contact TOPSKY service team or call us.

Caution



Keep children and pets away from the electric ceiling TV mount during operation. Unplug the power cable during a thunderstorm or if you do not intend to use the mount for a long time.



Be careful not to place your hands on or near the moving joints when folding or unfolding the TV mount to avoid any pinching.



Ensure there no obstacles around the TV mount's extension area.



It is strictly forbidden to disassemble the products privately to avoid that the failure of the products or the damage to the human body caused by electronic products, etc.



This product is designed for installation on wood ceiling joists or wood wall. DO NOT install on drywall alone.



Please read the following instructions carefully before start using the TV mount. The company does not bear any warranty or liability for damage and human injury caused by any abnormal operation.

Parts List



R (x1)
Turntable



C (x1)
Celing Template



O1(X4)
ST6.2x55mm
Screw



O2(X4)
Concrete Anchor



O3(X4)
16x6.5
Galvanized
Washer

TOOLS NEEDED:



O4(x4)
M6x16mm Screw



Phillips Screwdriver

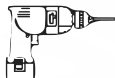

Drill



Pencil

NOTE: SOME HARDWARE INCLUDED MAY NOT BE USED

Assembly

STEP 1:Installing the Mount

※Please complete the code pairing between controller and remote control before assembling the TV mount to the ceiling.

OPTION A: Wooden ceilings

Using the Ceiling Template (C), mark the mounting holes at the exact location. Use a 4.5mm drill bit to drill a 2.2-inch-deep pilot hole. Screw the turntable into two M6×16 screws (O4), leaving a 5 mm gap with the turntable. Attach the Turntable (R) to the ceiling with 4 ST6.2x55mm screws (O1) and come with a 16×6.5 galvanized washer (O3). Hang Mount (A) so that the screws fit into the keyhole openings. Slide Mount (A) backwards and secure it with an additional M6×16 screw (O4).

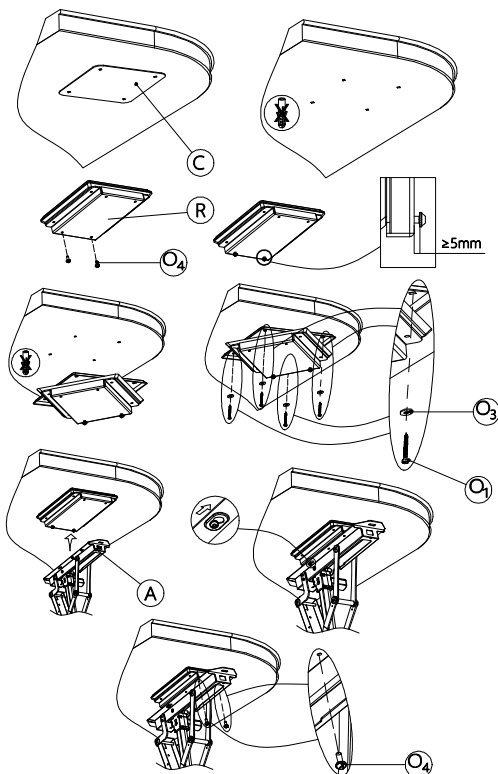

NOTE: If mounting to a wood beam ceiling, ensure the front and back holes are used for the main support if mount is in line with the beam. If perpendicular to the beam, use keyhole openings for the main support. **Do NOT** use included Concrete Anchors (O2) for wood or drywall.

OPTION B: Concrete ceiling

Using the Ceiling Template (C), mark the exact location of the mounting holes. Use a 2.4mm drill bit to drill a 10-inch deep pilot hole. Insert four Anchors (O2). Screw the Turntable (R) into two M6×16 screws, leaving a 5mm gap from the turntable. Attach the turntable to the ceiling with 4 ST6.2x55mm screws (O1) and come with a 16×6.5 galvanized washer (O3). Hang Mount (A) so that the screws fit into the keyhole openings. Slide Mount (A), M6×16 (O4) screwed in place . Tighten all screws.

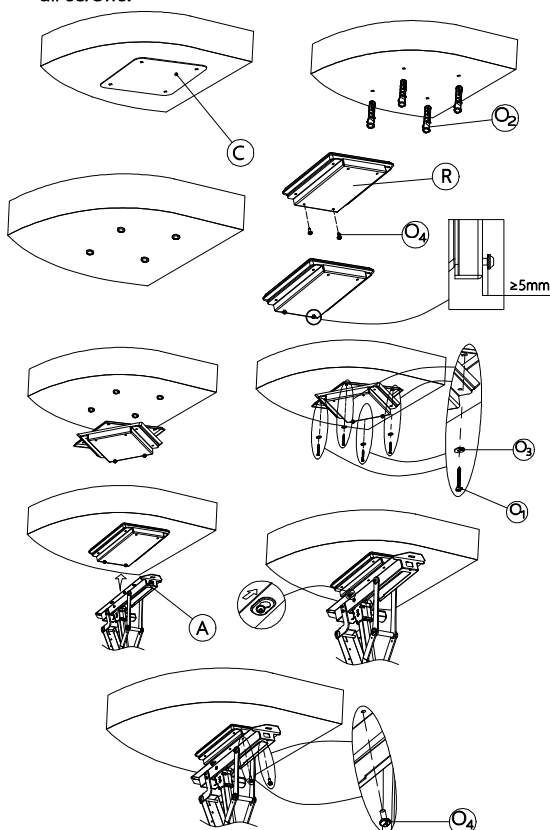

⚠ NOTE: O1 Concentric installation, do not tilt installation



Checklist

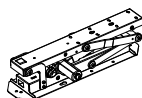

A (x1)
Mount



C (x1)
Template



O1 (x4)
ST6.2x55mm Screw



O2 (x4)
Concrete Anchor



O3 (x4)
Washer



O4 (x4)
M6x16mm Screw



R (x1)
Turntable

